

# 400 model 400

6

MODEL 400 THE ROLLING STEEL SERVICE DOOR

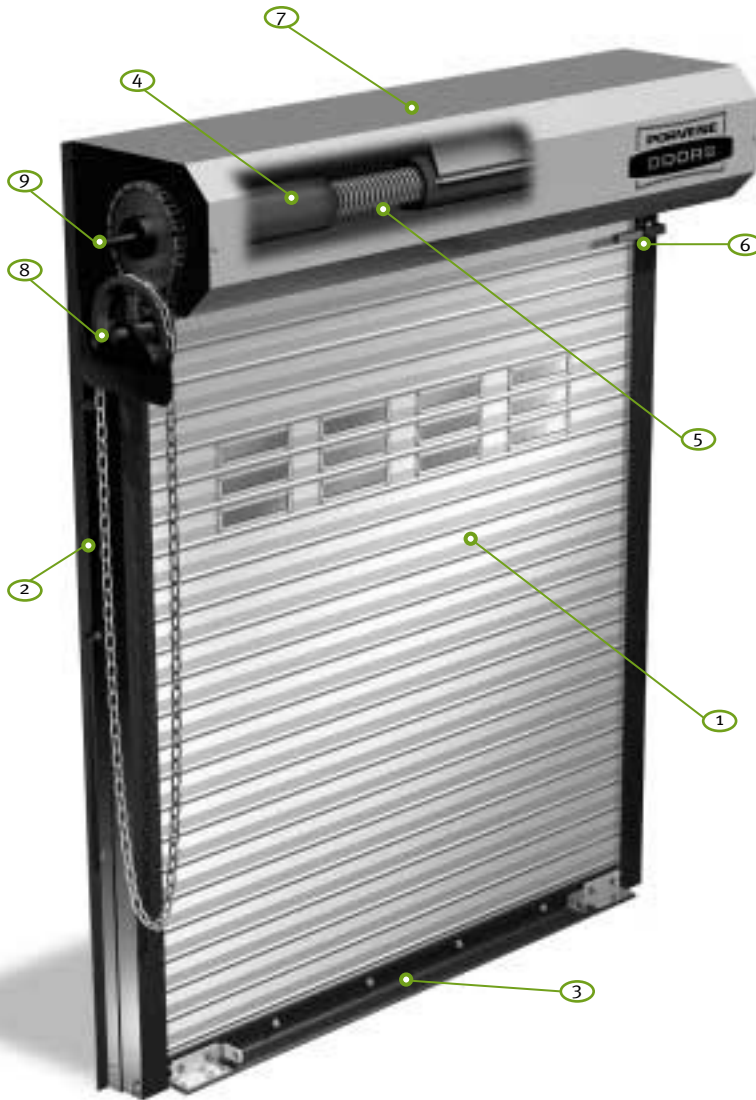

## Standard Features:

- 1. Steel Slat Curtain**
  - › All slats are manufactured from the highest quality galvanized steel with a baked enamel prime finish. Available in 18 ga., 20 ga., 22 ga. or 24 ga. flat or curved slat.
- 2. Guides**
  - › Minimum 3/16" structural steel angle. (Roll formed guides on 24 gauge doors up to 14'0" x 14'0".)
- 3. Bottom Bar**
  - › Two 2" X 2" X 1/8" thick structural steel angles form a rugged bottom bar assembly. A rubber bottom astragal helps to conform to floor irregularities and helps guard against weather, dirt, insects and rodents.
- 4. Pipe Barrel**
  - › Continuous 6" minimum diameter pipe to support curtain with no more than .03" of deflection per foot of width.
- 5. Counterbalance**
  - › Helical torsion springs are oil tempered and grease packed. Springs are designed for 20,000 cycles minimum and are accurately calculated for every door using Porvene's uniquely designed "Door Dynamometer".
- 6. Door Stops**
  - › Stops are located on the inside and outside of the guides for added safety.
- 7. Hood**
  - › 24 Gauge galvanized steel with a baked enamel prime finish hood that forms an enclosure at the top of the door.
- 8. Chain Hoist**
  - › Heavy duty #50 roller chain and sprockets combined with a smooth hand-chain provides for safe and efficient operation. Removal of chain hoist makes door Electric Operation ready without further modification or cost.
- 9. Sealed Ball Bearing**
  - › Self-aligning and allow free rotation of barrel.

## Model 400: The Rolling Steel Service Door

Porvene's 400 Series Service Doors offer 24/22/20/18 gauge slats for additional strength. Our new and innovative slat design reduces the snapping sounds that come from metal to metal contact common to rolling steel slat doors when the door is opening and closing. Powder Coating in a wide variety of colors is also available. This product line comes standard with Chain Operation and can be upgraded to Electric Operation.

## Other Options:

- › Dead bolt locks for wicket doors and pass doors
- › Inverted curtain for exterior mounting
- › Slope strip (for sloped floors)
- › Powder coating available
- › Cylinder lock
- › Cast iron endlocks/windlocks
- › Higher than 20 P.S.F. wind loading available
- › High cycle options 150,000 cycles
- › Electric interlocks

# options

Options:



> Flat Slat



> Vented Slat



> Curved Slat



> Screen Slat

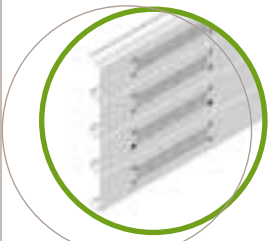

> Vision Slat

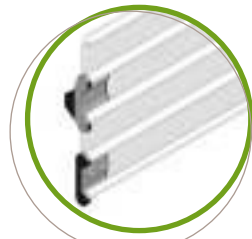

> Malleable Endlocks  
Windlocks



> Pass Door Provides roll-up and pass door convenience while maintaining access to full opening width



> Thru-Wall Chain Drive The option is used when operation is desired from the opposite side of the wall



> Double Reduction Drive For easy operation on larger doors



> Safety Break Bearing Prevents door from free falling in the event of counterbalance failure

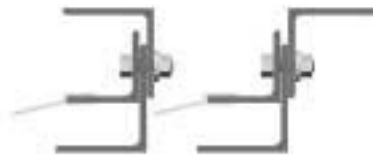

> Weather Seal Guides

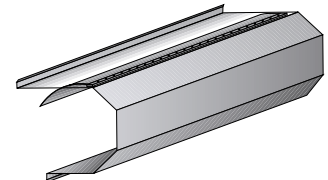

> Hood Baffle Reduces the infiltration of weather, dust, insects and rodents

## Dura-Finish Paint Process

The Porvene process is designed to give a longer life, with less maintenance and much better protection against the elements such as weather and dust. Our method produces one of the best systems in our industry for a longer lasting and more maintenance free finish. Our system produces one of the thickest top coat finishes in our industry.

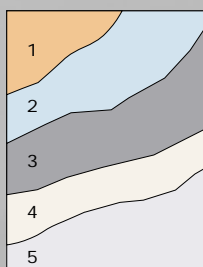

1. Strip steel per ASTM A-526.
2. Hot dip galvanized-G90 coating per ASTM A-525.
3. Bonderized for prime coat adhesion.
4. Corrosion inhibiting primer-minimum thickness (.2) mils on each side.
5. Dura finish (white polyester top coat minimum thickness 1.0 mill front and back side.)